

# Summer Housing Ideas

Using modular movable/removable units  
beginning summer 2022

Solve the seasonal labor shortage problem

George Hall – Homer EDC

## Eight Bed Sleeper Unit

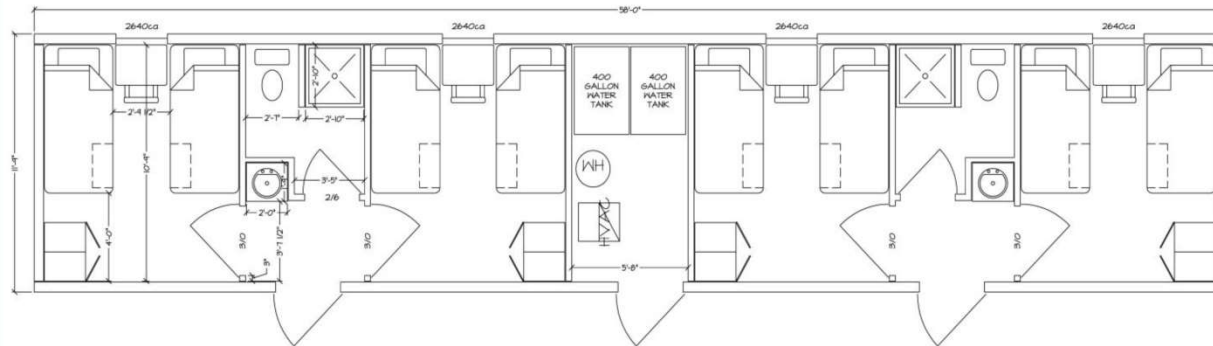

- 12' x 58' skid mounted module
- Arctic Capable module
- 4 each double occupancy resident bedrooms
- 2 each semi-private bathrooms per unit
- Each resident room provides; flat screen television, 1- built-in desk, 2-built-in captains beds, 1-built-in wardrobe cabinet, and 2 - Deluxe X-Large Long mattresses.
- Electric heat
- Internal Potable Water storage tank with 300 gallon capacity
- Quick disconnect, no-hub, outlet for Waste Water discharge to tank or system (provided by other)

### **Dimensions for Shipping:**

Length: 60'  
Width: 12'  
Height: 12'4"  
Est Weight: 34,800 lbs  
Skid Mounted

### **Electrical Requirements:**

Connector for Panel "A" = 240 1P /// Connected Load : 178 Amps  
Connector for Panel F-1 = 240 1P /// Connected Load : 85 Amps  
Power Factor = .8  
Gen Set size = 63 KVA (estimate only)

## Major issues

- Cost? – Purchase or lease?
- Location? – In the city... most certainly Shuttle bus service
- How many beds? 8 people per unit.  
64 beds available in ANC
- How much to charge for rent?  
cost recovery or subsidy?
- Who to charge for rent  
individuals, or businesses that employ them
- Winter Use? Yes/No
- Term of need? 5 yrs? Deep Water Doc?
- Facilities rules and management

## ROM Cost Data

8 Person sleeper \$110,000

\$13,750 per person

Common Galley \$130,000

Facilities Security and maintenance costs

Location- Cost to prep land

20' x 60' per sleeper

Sewage hookups

Electricity

Parking/Ingress

Units have long life and can be repurposed