

QUIET CREEK SUBDIVISION - HOMER, ALASKA OVERSIZING

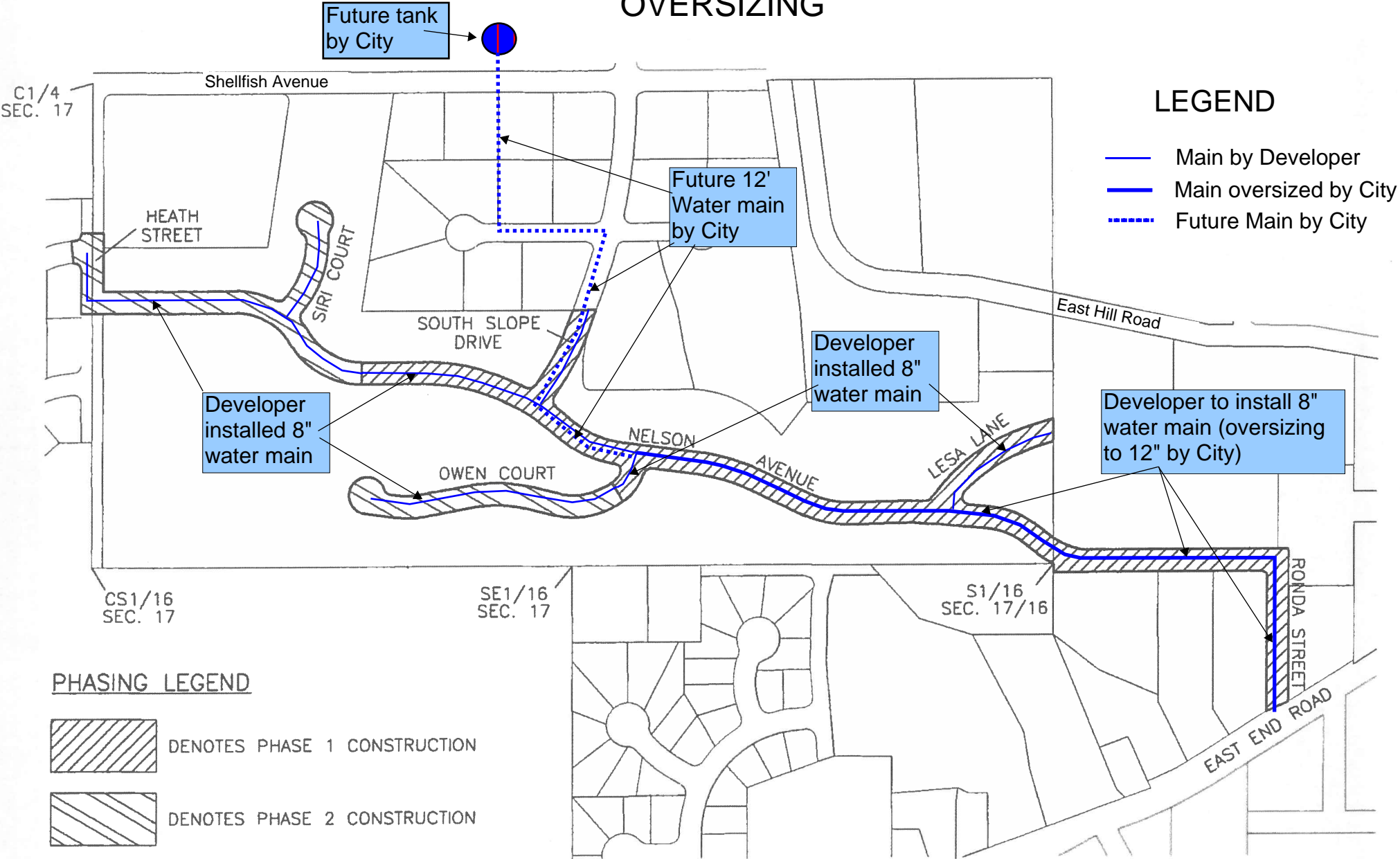

Future tank
by City

Future 12'
Water main
by City

Developer
installed 8"
water main

Developer
installed 8"
water main

Developer to install 8"
water main (oversizing
to 12" by City)

C1/4
SEC. 17

Shellfish Avenue

HEATH STREET

SIRT COURT

SOUTH SLOPE DRIVE

NELSON AVENUE

OWEN COURT

LESA LANE

East Hill Road

CS1/16
SEC. 17

SE1/16
SEC. 17

S1/16
SEC. 17/16

RONDA STREET

EAST END ROAD