



**CITY OF HOMER
PUBLIC WORKS DEPARTMENT**

Dan Gardner, PW Superintendent
3575 Heath St.
Homer, Alaska 99603

Telephone: (907)235-3170

Fax: (907)235-3145

EMAIL : dgardner@ci.homer.ak.us

Memorandum 16-043

To: Katie Koester, City Manager
From: Dan Gardner, Superintendent
Thru: Carey Meyer, PW Director
Date: February 16, 2016
Subject: PROPOSED STREETS REPAVING PROGRAM - 2016

Discussion

In 2006, 2009, and 2012, the Public Works Department successfully completed three much needed repaving projects which encompassed 13 streets totaling 4.52 miles. The majority of these streets were originally paved in 1983/84 era.

We are again proposing a 2016 Repaving Project which will include another 9 streets, seven of which were originally paved between 1983/93 and two streets that were originally paved in 1999.

Project Costs Estimates

Streets Repaving: \$578,788 (includes design, admin and construction costs)

Attached please find two spreadsheets with detailed project costs estimates.

Recommendation

1. Expend an amount "not to exceed" \$638,000.00 this fiscal year from the H.A.R.T. fund for the design & construction to include grinding of existing asphalt and repave the streets as identified on the attached spreadsheets. This amount has a 10 percent contingency to the attached estimate.

Fiscal Note

Currently the HART Fund contains approximately 7 million dollars as of end of year 2015.

It is recommended that as any discussion takes place where ending or modifying the HART program takes place, that the continual funding of asphalt replacement is part of that discussion. If this program is ever dissolved, a depreciation fund should be firmly established to replace failing asphalt as operations budgets have not been able to support the needed paving projects.

Enc: Recommended streets to repave
Estimated construction costs
Maps

**City of Homer - Public Works Department
2016 Roads Repaving Program**

Road Name	Year Paved	From	To	Asphalt Condition	Roadway Length Linear Feet	Pavement Width Feet	Total Sq Yds
E. Bunnell St.	1999	Main St.	Beluga Place	poor	700	24	1,867
Beluga Place	1999	E. Bunnell	Parking Lot	poor	600	24	1,600
Early Spring St.	1983/84	Mark White Ave.	Aspen Lane	poor	730	24	1,947
Mark White Ave.	1983/84	Rochelle Rd.	Early Spring St.	poor	360	24	960
Mullikin Street	1989	Fairview Ave.	Soundview Ave.	poor	650	24	1,733
Clover Lane	1993	East End Road	End of Road	poor	1,320	24	3,520
Clover Place	1993	Clover Lane	Cul-de-Sac	poor	305	24	813
Hillview Place	1993	Clover Lane	Cul-de-Sac	poor	210	24	560
Kachemak Way	1993	Bayview Ave.	North end of road	poor	850	24	2,267
					5,725	Total	15,267

**Priority 1
Group "A"**

2016

City of Homer - Public Works Department
2016 Roads Repaving Program

Estimated Construction Cost

Estimated Construction Costs (grind 4" depth, regrade, adjust utilities & repave @ 2" new asphalt)

Group "A" Roads - Repave

Street Name	Total Sq Yds	Grind @ \$5.25/sy	Regrade @ \$0.50 / sy	Level Course @ \$50 / ton	2" AC Repave @ \$17.50/sy	(14 SSMH's) Adjust SS/SDMH \$500 ea	(12 GV's) Adjust Valve Box \$500 ea	Striping @1.25/lf	Mobe @ 20% Const.	Total Estimated
E. Bunnell Street	1,867	\$ 9,800.00	\$ 933.33	\$ 2,000.00	\$ 32,666.67	\$ 2,000.00	\$ 1,000.00		\$ 9,680.00	\$ 58,080.00
Beluga Place	1,600	\$ 8,400.00	\$ 800.00	\$ 2,000.00	\$ 28,000.00					
Early Spring St.	1,947	\$ 10,220.00	\$ 973.33	\$ 2,000.00	\$ 34,066.67	\$ 500.00	\$ 1,000.00	\$ 3,781.25	\$ 9,752.00	\$ 62,293.25
Mark White Ave.	960	\$ 5,040.00	\$ 480.00	\$ 2,000.00	\$ 16,800.00	\$ 1,000.00	\$ 500.00	\$ 3,375.00	\$ 5,164.00	\$ 34,359.00
Mullikin Street	1,733	\$ 9,100.00	\$ 866.67	\$ 2,500.00	\$ 30,333.33	\$ 500.00	\$ 2,000.00	\$ 3,312.50	\$ 9,060.00	\$ 57,672.50
Clover Lane	3,520	\$ 18,480.00	\$ 1,760.00	\$ 2,500.00	\$ 61,600.00	\$ 1,500.00	\$ 500.00		\$ 17,268.00	\$ 103,608.00
Clover Place	813	\$ 4,270.00	\$ 406.67	\$ 1,000.00	\$ 14,233.33	\$ 500.00	\$ 500.00		\$ 4,182.00	\$ 25,092.00
Hillview Place	560	\$ 2,940.00	\$ 280.00	\$ 1,000.00	\$ 9,800.00	\$ 500.00	\$ 500.00			
Kachemak Way	2,267	\$ 11,900.00	\$ 1,133.33	\$ 3,000.00	\$ 39,666.67	\$ 1,000.00	\$ 1,500.00		\$ 11,640.00	\$ 69,840.00
Totals	15,267	\$ 80,150.00	\$ 7,633.33	\$ 18,000.00	\$ 267,166.67	\$ 7,500.00	\$ 7,000.00	\$ 10,468.75	\$ 66,746.00	\$ 410,944.75

Traffic Control LS \$ 5,000.00

Total Construction \$ 415,944.75
10% Contingency \$ 41,594.48
Grand Total Construction \$ 457,539.23

Estimated Total Project Costs (construction, design & admin overhead)

Construction Costs	\$ 457,539.23
Design/Inspect @ 10%	\$ 45,753.92
Admin @ 15%	\$ 75,493.97
Total Pave/Repave Project	\$ 578,787.12



Mullikin St.

E. Bunnell & Beluga Place

Kachemak Way

Mark White St.
Early Spring St.

Clover Lane
Clover Place
Hillview Place

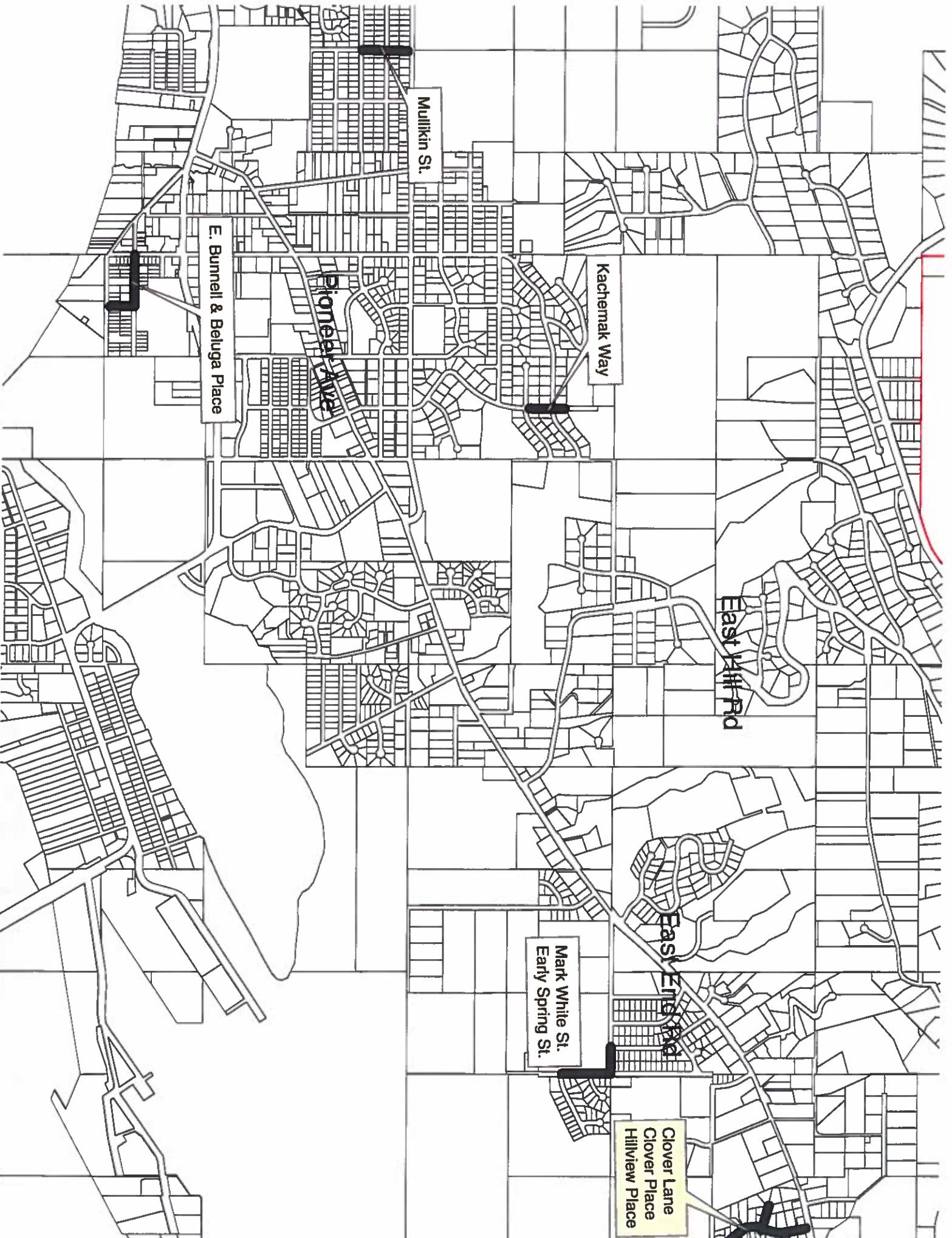

Mulikin St.

E. Bunnell & Beluga Place

Pioneer Ave

Kachemak Way

East Hill Rd

East Elm Rd

Mark White St.
Early Spring St.

Clover Lane
Clover Place
Hillview Place