

HOMER PUBLIC SAFETY BUILDING - Decisional Matrix

Decisional Elements		Option 1 Combined Police/Fire - Original Program	Option 2 Combined Police/Fire - Reduced Program	Option 3 Police Only/Upgrade Existing Fire Station	
Cost	Total estimated cost	\$28,749,697	\$23,040,510	\$14,901,904	
	Additional annual maintenance (using \$8/sf/yr as estimated annual cost)	\$301,000	\$204,000	\$144,000	
	Annual bond repayment (range: 3 to 4%)	20 yrs	\$1,930,000 – 2,110,000	\$1,550,000 – 1,700,000	\$1,000,000 – 1,100,000
		30 yrs	\$1,470,000 - 1,660,000	\$1,180,000 - 1,330,000	\$760,000 - 864,000
		50 yrs	\$1,120,000 – 1,340,000	\$896,000 – 1,070,000	\$579,000 – 694,000
Note: in 2015, 1 mil Property Tax = \$660,000 and 1% Sales Tax = \$1.7 million					
Other	HERC Gym – disposition	HERC Gym is demolished	HERC Gym is demolished	HERC Gym remains	
	West B-Ball (outdoor) courts	B-Ball courts demolished	B-Ball courts demolished	B-Ball courts demolished	
	Skateboard park – disposition	Skateboard park is demolished	Skateboard park is demolished	Skateboard park is demolished	
	Public Works Shop	Shop space & storage demolished and needs to be replaced	Shop space & storage demolished and needs to be replaced	Shop space & storage demolished and needs to be replaced	
Estimated Cost & Size (based on Dec 2015/"Concept" level design)		Shared: Site/Civil cost: \$ 2,205,500 Police bldg : (32,211 sf) Fire bldg : (19,688 sf) Building cost: \$ 21,246,131 Design/Inspection/Admin : \$ 5,298,066	Shared: Site/Civil cost: \$ 2,205,500 Police bldg : (23,728 sf) Fire bldg : (16,086 sf) Building Cost: \$ 16,677,906 Design/Inspection/Admin : \$ 4,157,104	Site/Civil cost (Police only): \$ 1,224,700 Police bldg: (24,134 sf) \$ 9,982,281 Fire (upgrade existing facility): \$ 975,000 Design/Inspection/Admin: \$2,727,703	

OPTION 1 : LONG TERM COMBINED REPLACE POLICE/FIRE STATIONS

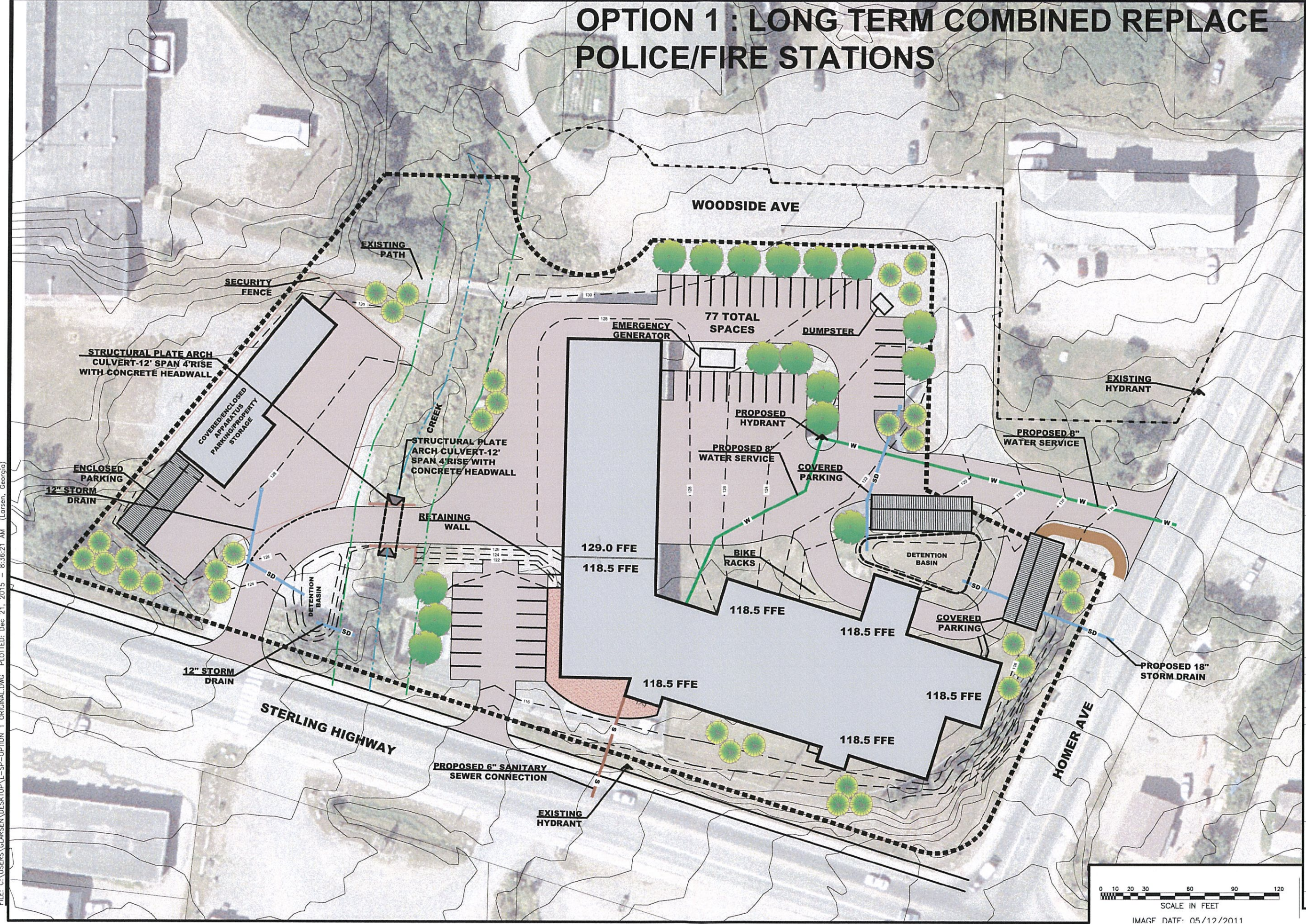

FILE: C:\USERS\GLARSEN\DESKTOP\1-SP-OPTION 1 ORIGINAL.DWG PLOTTED: Dec 21, 2015 - 8:36:21 AM (Larsen, Georgia)

Date Stamped:

By	Date

Stantec

2515 A Street
Anchorage, Alaska 99503
Phone: (907) 276-4245
Fax: (907) 258-4653
www.stantec.com

Project: HOMER PUBLIC SAFETY BUILDING

City of Homer Homer, Alaska 99603	Project Mgr. DRS
Drawn	
Checked	
Date	12/17/2015

Sheet Contents:
OPTION 1

Sheet No.: **L1.1**

Project Number: 204600234

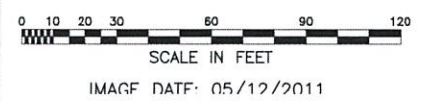

THIS DRAWING IS HALF-SIZE AT 11x17"

PROPOSED FIRE STATION

FIRE ADMIN

PUBLIC ENTRY

T.O.C. FIRE APPARATUS +10'-11"

POLICE LOBBY

FIRE LOBBY

DISPATCH

EMERGENCY EXIT STAIR

JAIL

PROPERTY + EVIDENCE

PROPOSED POLICE FACILITY

POLICE OFFICER + STAFF ENTRY

INVESTIGATION + PATROL

POLICE STATION - SF BY DEPT.	
DEPARTMENT	AREA
DISPATCH	3381 SF
INVESTIGATION + PATROL	5411 SF
JAIL	4560 SF
POLICE LOBBY	1429 SF
PROPERTY + EVIDENCE	4850 SF
RANGE	2359 SF
TRAINING + FITNESS	10221 SF
Grand total:	128 32211 SF

FIRE STATION - SF BY DEPT.	
DEPARTMENT	AREA
FIRE ADMIN	4173 SF
FIRE APPARATUS	7749 SF
FIRE APPARATUS SUPPORT	1435 SF
FIRE LIVING	4167 SF
FIRE LOBBY	2165 SF
Grand total:	41 19688 SF

Color by Department Legend

- DISPATCH
- FIRE ADMIN
- FIRE APPARATUS
- FIRE APPARATUS SUPPORT
- FIRE LIVING
- FIRE LOBBY
- INVESTIGATION + PATROL
- JAIL
- POLICE LOBBY
- PROPERTY + EVIDENCE
- RANGE
- TRAINING + FITNESS

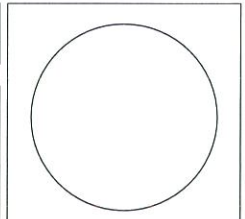

Date Stamped:

No.	Date	By	Revision

2515 'A' Street
Anchorage, Alaska 99503
Phone: (907) 276-4245
Fax: (907) 258-4653
www.stantec.com

Project:
HOMER PUBLIC SAFETY BUILDING OPTION 1
COMBINED POLICE/FIRE - ORIGINAL PROGRAM

City of Homer
Homer, Alaska 99603

Project Mgr. DRS

Drawn

Checked

Date 12/08/15

Sheet Contents:
LEVEL 1 FLOOR PLAN

Sheet No.:

A-111

Project Number: 204600234





POLICE STATION - SF BY DEPT.	
DEPARTMENT	AREA
DISPATCH	3381 SF
INVESTIGATION + PATROL	5411 SF
JAIL	4560 SF
POLICE LOBBY	1429 SF
PROPERTY + EVIDENCE	4850 SF
RANGE	2359 SF
TRAINING + FITNESS	10221 SF
Grand total:	32211 SF

FIRE STATION - SF BY DEPT.	
DEPARTMENT	AREA
FIRE ADMIN	4173 SF
FIRE APPARATUS	7749 SF
FIRE APPARATUS SUPPORT	1435 SF
FIRE LIVING	4167 SF
FIRE LOBBY	2165 SF
Grand total:	19688 SF

Color by Department Legend

- DISPATCH
- FIRE ADMIN
- FIRE APPARATUS
- FIRE APPARATUS SUPPORT
- FIRE LIVING
- FIRE LOBBY
- INVESTIGATION + PATROL
- JAIL
- POLICE LOBBY
- PROPERTY + EVIDENCE
- RANGE
- TRAINING + FITNESS

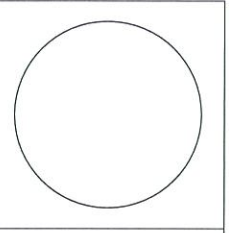

Date Stamped:

By	Revision	Date

Stantec
 2515 A Street
 Anchorage, Alaska 99503
 Phone: (907) 276-4245
 FAX: (907) 258-4653
 www.stantec.com

Project:
HOMER PUBLIC SAFETY BUILDING OPTION 1
 COMBINED POLICE/FIRE - ORIGINAL PROGRAM

City of Homer
 Homer, Alaska 99603
 Project Mgr. DRS
 Drawn
 Checked
 Date 10/24/14

Sheet Contents:
LEVEL 2 FLOOR PLAN
 Sheet No.:

A-112
 Project Number: 204600234



POLICE STATION ROOM SCHEDULE		
DEPARTMENT	ROOM NAME	AREA
DISPATCH	DEPT. BREAK ROOM	288 SF
DISPATCH	DISPATCH BREAK ROOM	216 SF
DISPATCH	DISPATCH CONSOLES	1159 SF
DISPATCH	DISPATCH EQUIP.	140 SF
DISPATCH	HALLWAY	105 SF
DISPATCH	HALLWAY	240 SF
DISPATCH	LOCKERS	160 SF
DISPATCH	RECEP.	126 SF
DISPATCH	STAIR	160 SF
DISPATCH	SUPERVISOR	133 SF
DISPATCH	W/C	80 SF
DISPATCH	W/C	80 SF
DISPATCH	W/C	144 SF
DISPATCH	W/C	144 SF
DISPATCH	WORK/FILES	206 SF
INVESTIGATION + PATROL	BREIFING SQUAD	375 SF
INVESTIGATION + PATROL	CUBICAL	66 SF
INVESTIGATION + PATROL	CUBICAL	68 SF
INVESTIGATION + PATROL	CUBICAL	76 SF
INVESTIGATION + PATROL	CUBICAL	80 SF
INVESTIGATION + PATROL	DET.	150 SF
INVESTIGATION + PATROL	DET.	150 SF
INVESTIGATION + PATROL	DET.	150 SF
INVESTIGATION + PATROL	HALLWAY	1781 SF
INVESTIGATION + PATROL	INT.	120 SF
INVESTIGATION + PATROL	LIEUT.	144 SF
INVESTIGATION + PATROL	PATROL STG.	150 SF
INVESTIGATION + PATROL	POLI	96 SF
INVESTIGATION + PATROL	POLICE CHEIF	216 SF
INVESTIGATION + PATROL	REPORT/ OFFICE	375 SF
INVESTIGATION + PATROL	SGT.	179 SF
INVESTIGATION + PATROL	SGT.	179 SF
INVESTIGATION + PATROL	SGT.	180 SF
INVESTIGATION + PATROL	SGT.	180 SF
INVESTIGATION + PATROL	SGT.	181 SF
INVESTIGATION + PATROL	SOFT INTERVIEW	144 SF
INVESTIGATION + PATROL	STAIR	190 SF
INVESTIGATION + PATROL	WORK/COPY	181 SF
JAIL	CELL	76 SF
JAIL	CELL	76 SF
JAIL	CELL	76 SF
JAIL	CELL	115 SF
JAIL	CELL	115 SF
JAIL	CELL	116 SF
JAIL	CELL	116 SF
JAIL	CELL	116 SF
JAIL	CELL	116 SF
JAIL	CELL	116 SF
JAIL	CELL	116 SF
JAIL	CONTROL WS	280 SF
JAIL	HALLWAY	228 SF
JAIL	HOLD	80 SF
JAIL	INTER - VIEW	90 SF
JAIL	JAN./ REC.	113 SF
JAIL	JUV. HOLD	90 SF
JAIL	LAUNDRY	111 SF
JAIL	MECH.	438 SF
JAIL	MEN	205 SF
JAIL	PRE BOOK	916 SF
JAIL	RELEASE	125 SF
JAIL	SHWR	40 SF
JAIL	SOFT INTERVIEW	203 SF
JAIL	TEMP. EVIDENCE	112 SF
JAIL	UNIFORMS/ BEDDING	113 SF
JAIL	VISIT	36 SF
JAIL	VISIT	36 SF
JAIL	VISUAL CUTOFF	4 SF
JAIL	VISUAL CUTOFF	4 SF
JAIL	VISUAL CUTOFF	7 SF
JAIL	VISUAL CUTOFF	8 SF
JAIL	VISUAL CUTOFF	8 SF
JAIL	VISUAL CUTOFF	10 SF
JAIL	W.C.	40 SF
JAIL	W/C	70 SF
JAIL	WOMEN	156 SF

POLICE STATION ROOM SCHEDULE		
DEPARTMENT	ROOM NAME	AREA
POLICE LOBBY	ELEV.	80 SF
POLICE LOBBY	ELEV.	80 SF
POLICE LOBBY	ELEV. EQUIP.	90 SF
POLICE LOBBY	POLICE LOBBY	215 SF
POLICE LOBBY	POLICE LOBBY	960 SF
PROPERTY + EVIDENCE	BOOTS	51 SF
PROPERTY + EVIDENCE	BUNK	171 SF
PROPERTY + EVIDENCE	DECON/ DRESS	157 SF
PROPERTY + EVIDENCE	DRUGS	65 SF
PROPERTY + EVIDENCE	EQUIP./ STOR.	125 SF
PROPERTY + EVIDENCE	EVIDENCE RECIEVE	258 SF
PROPERTY + EVIDENCE	EVIDENCE STOR.	139 SF
PROPERTY + EVIDENCE	EVIDENCE SUBMIT	164 SF
PROPERTY + EVIDENCE	GEAR	51 SF
PROPERTY + EVIDENCE	GUNS	65 SF
PROPERTY + EVIDENCE	HALLWAY	79 SF
PROPERTY + EVIDENCE	HALLWAY	131 SF
PROPERTY + EVIDENCE	HALLWAY	296 SF
PROPERTY + EVIDENCE	LDRY	88 SF
PROPERTY + EVIDENCE	LONG TERM ECIDENCE STOR.	835 SF
PROPERTY + EVIDENCE	LONG TERM EVIDENCE STOR.	255 SF
PROPERTY + EVIDENCE	MARI- JAUANA	79 SF
PROPERTY + EVIDENCE	PROP.	49 SF
PROPERTY + EVIDENCE	SALLY PORT	1024 SF
PROPERTY + EVIDENCE	STOR.	Redunda nt Room
PROPERTY + EVIDENCE	STOR.	20 SF
PROPERTY + EVIDENCE	SUPPLY	81 SF
PROPERTY + EVIDENCE	UNIFORM	88 SF
PROPERTY + EVIDENCE	VEHICLE IMPOUND BAY	580 SF
RANGE	ARMORY	118 SF
RANGE	CONTROL	123 SF
RANGE	GUN CLEAN	93 SF
RANGE	RANGE	1954 SF
RANGE	STOR.	72 SF
TRAINING + FITNESS	ASST. FIRE CHIEF	160 SF
TRAINING + FITNESS	BUNK	126 SF
TRAINING + FITNESS	BUNK	156 SF
TRAINING + FITNESS	BUNK	168 SF
TRAINING + FITNESS	BUNK	168 SF
TRAINING + FITNESS	BUNK	182 SF
TRAINING + FITNESS	BUNK	196 SF
TRAINING + FITNESS	FIRE/POLICE TRAINING	1254 SF
TRAINING + FITNESS	HALLWAY	1335 SF
TRAINING + FITNESS	LIBRARY	120 SF
TRAINING + FITNESS	LOCKERS	416 SF
TRAINING + FITNESS	MAN FIRE SHOWER + LOCKERS	703 SF
TRAINING + FITNESS	MAN POLICE SHOWER + LOCKERS	1028 SF
TRAINING + FITNESS	PHYSICAL TRAINING + EXERCISE	2460 SF
TRAINING + FITNESS	STAIR	160 SF
TRAINING + FITNESS	STAIR	190 SF
TRAINING + FITNESS	STOR.	78 SF
TRAINING + FITNESS	TRAINING STOR.	203 SF
TRAINING + FITNESS	W FIRE SHOWER + LOCKERS	519 SF
TRAINING + FITNESS	WOMAN POLICE SHOWER + LOCKERS	600 SF

Grand total: 128 32208 SF

POLICE STATION - SF BY DEPT.	
DEPARTMENT	AREA
DISPATCH	3381 SF
INVESTIGATION + PATROL	5411 SF
JAIL	4560 SF
POLICE LOBBY	1429 SF
PROPERTY + EVIDENCE	4850 SF
RANGE	2359 SF
TRAINING + FITNESS	10221 SF

Grand total: 128 32211 SF

FIRE STATION ROOM SCHEDULE		
DEPARTMENT	ROOM NAME	AREA
FIRE ADMIN	FIRE CHEIF	210 SF
FIRE ADMIN	FIRE MARSHAL	158 SF
FIRE ADMIN	FOOD	99 SF
FIRE ADMIN	HALLWAY	721 SF
FIRE ADMIN	HOSE TOWER	128 SF
FIRE ADMIN	JAN.	44 SF
FIRE ADMIN	M+E	36 SF
FIRE ADMIN	MECH.	445 SF
FIRE ADMIN	MEDICAL SUPPLY	278 SF
FIRE ADMIN	NEW/TURN OUTS	203 SF
FIRE ADMIN	PLAN REVIEW	137 SF
FIRE ADMIN	RECEPTION/ DEPT. SERVICES	412 SF
FIRE ADMIN	SEVICES SPECIALISTS	300 SF
FIRE ADMIN	STORAGE	169 SF
FIRE ADMIN	VOLUNTEER PRODUCTION	348 SF
FIRE ADMIN	W.C.	75 SF
FIRE ADMIN	W.C.	77 SF
FIRE ADMIN	W.C.	166 SF
FIRE ADMIN	W.C.	166 SF
FIRE APPARATUS	FIRE APPARATUS	6499 SF
FIRE APPARATUS	VEHICLE BAY	1250 SF
FIRE APPARATUS SUPPORT	AIR COMP. + STOR.	125 SF
FIRE APPARATUS SUPPORT	DECON SHOWERS	196 SF
FIRE APPARATUS SUPPORT	EQUIP./ SUPPLIES	66 SF
FIRE APPARATUS SUPPORT	FACILITY MAINT.	210 SF
FIRE APPARATUS SUPPORT	HOSE W/D	65 SF
FIRE APPARATUS SUPPORT	SHOP	287 SF
FIRE APPARATUS SUPPORT	STOR.	321 SF
FIRE APPARATUS SUPPORT	TURN OUT W/D	165 SF
FIRE LIVING	DAY ROOM	2150 SF
FIRE LIVING	DINING	1035 SF
FIRE LIVING	HOSE TOWER	128 SF
FIRE LIVING	JAN.	97 SF
FIRE LIVING	KITCHEN	636 SF
FIRE LIVING	PANTRY	121 SF
FIRE LOBBY	BREEZE WAY	363 SF
FIRE LOBBY	EQUIP	105 SF
FIRE LOBBY	FIRE LOBBY	427 SF
FIRE LOBBY	FIRE LOBBY	1070 SF
FIRE LOBBY	HALLWAY	109 SF
FIRE LOBBY	IT	90 SF

Grand total: 41 19688 SF

FIRE STATION - SF BY DEPT.	
DEPARTMENT	AREA
FIRE ADMIN	4173 SF
FIRE APPARATUS	7749 SF
FIRE APPARATUS SUPPORT	1435 SF
FIRE LIVING	4167 SF
FIRE LOBBY	2165 SF

Grand total: 41 19688 SF

TOTAL - SF. BY DEPT.	
DEPARTMENT	AREA
DISPATCH	3381 SF
FIRE ADMIN	4173 SF
FIRE APPARATUS	7749 SF
FIRE APPARATUS SUPPORT	1435 SF
FIRE LIVING	4167 SF
FIRE LOBBY	2165 SF
INVESTIGATION + PATROL	5411 SF
JAIL	4560 SF
POLICE LOBBY	1426 SF
PROPERTY + EVIDENCE	4850 SF
RANGE	2359 SF
TRAINING + FITNESS	10221 SF

Grand total: 169 51896 SF



2915 K Street
Anchorage, Alaska 99503
Phone: (907) 276-4245
Fax: (907) 238-4653
www.stantec.com

Date Stamped:

By	Revision	Date	REVISIONS	
			No.	Date

Project: HOMER PUBLIC SAFETY BUILDING OPTION 1

COMBINED POLICE/FIRE - ORIGINAL PROGRAM

City of Homer
Homer, Alaska 99603

Project Mgr.	DRS
Drawn	
Checked	
Date	12/08/15

Sheet Contents:

ROOM SCHEDULE

Sheet No.:

A-600

Project Number: 204600234

THIS DRAWING IS HALF-SIZE AT 11"x17"

OPTION 2 : SHORT TERM COMBINED REPLACE POLICE/FIRE STATIONS

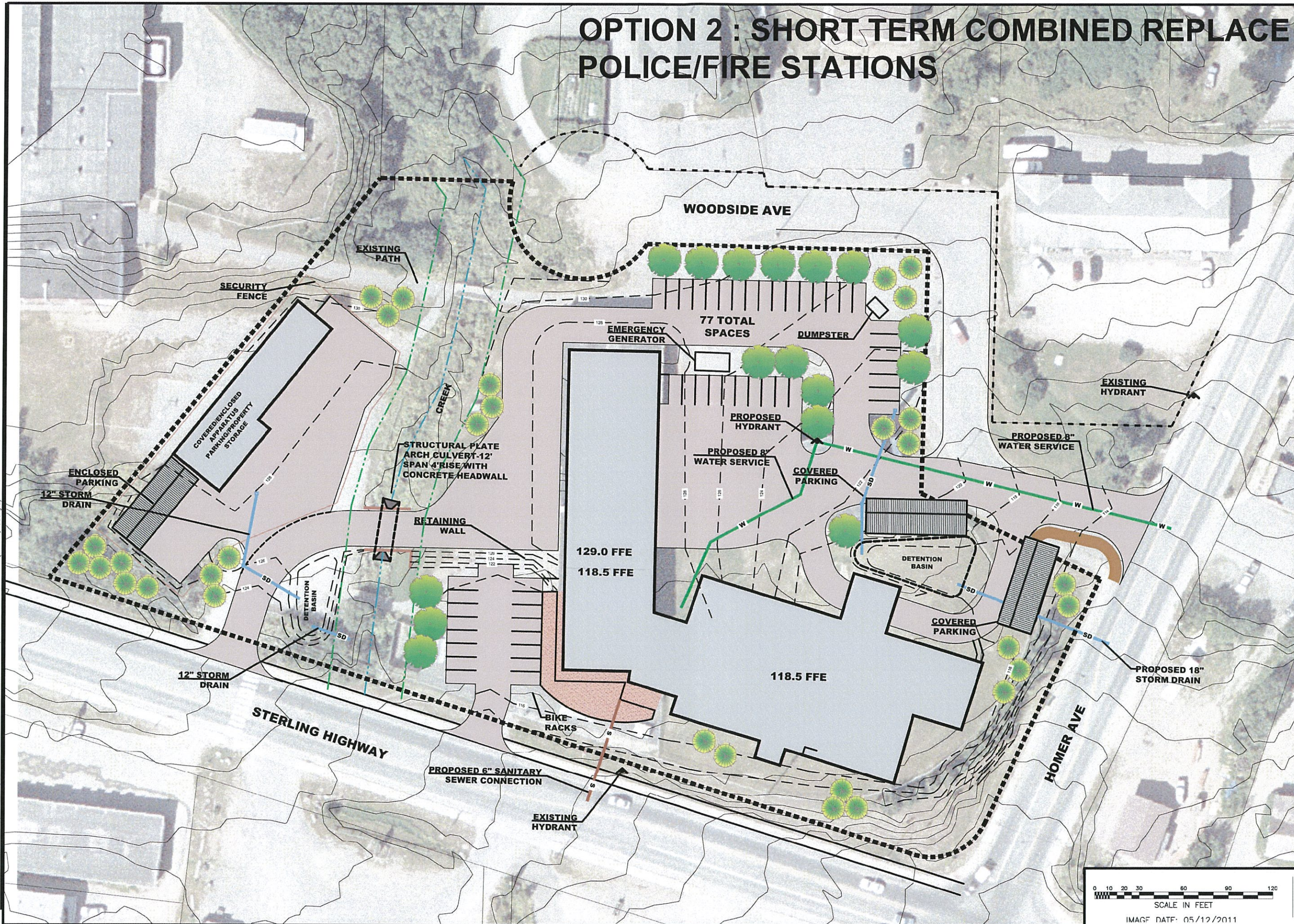

FILE: C:\USERS\GLARSEN\DESKTOP\L-SP-OPTION 2.DWG PLOTTED: Dec 21, 2015 - 8:38:36 AM (Larsen, Georgia)

Date Stamped:	
No.	Date



251 S.A. Street
 Anchorage, Alaska 99503
 Phone: (907) 276-4245
 FAX: (907) 258-4633
 www.stantec.com

Project: HOMER PUBLIC SAFETY BUILDING

City of Homer	Homer, Alaska 99603
Project Mgr.	DRS
Drawn	
Checked	
Date	12/17/2015

Sheet Contents:
OPTION 2

Sheet No.:
L1.2

Project Number: 204600234

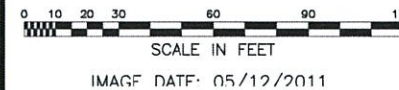

THIS DRAWING IS HALF-SIZE AT 11x17"

C:\Users\Public\Documents\Local_Revit_Files\homer_safety_bldg_204600234_OPTION 2_gomenn.rvt

1 LEVEL 1
A-111 1/16" = 1'-0"

PROPOSED FIRE STATION

FIRE ADMIN

T.O.C. FIRE APPARATUS +10'-11"

FIRE LOBBY

PUBLIC ENTRY

POLICE LOBBY

DISPATCH

EMERGENCY EXIT STAIR

JAIL

124.6

PROPERTY + EVIDENCE

POLICE OFFICER + STAFF ENTRY

PROPOSED POLICE FACILITY

INVESTIGATION + PATROL

POLICE STATION - SF BY DEPT.	
DEPARTMENT	AREA
DISPATCH	2570 SF
INVESTIGATION + PATROL	4568 SF
JAIL	4071 SF
POLICE LOBBY	894 SF
PROPERTY + EVIDENCE	4879 SF
RANGE	2540 SF
TRAINING + FITNESS	4207 SF
Grand total:	23728 SF

FIRE STATION - SF BY DEPT.	
DEPARTMENT	AREA
FIRE ADMIN	3086 SF
FIRE APPARATUS	7253 SF
FIRE APPARATUS SUPPORT	1343 SF
FIRE LIVING	3343 SF
FIRE LOBBY	1061 SF
Grand total:	16086 SF

COLOR LEGEND BY DEPARTMENT

- DISPATCH
- EXISTING
- FIRE ADMIN
- FIRE APPARATUS
- FIRE APPARATUS SUPPORT
- FIRE LIVING
- FIRE LOBBY
- INVESTIGATION + PATROL
- JAIL
- POLICE LOBBY
- PROPERTY + EVIDENCE
- RANGE
- TRAINING + FITNESS

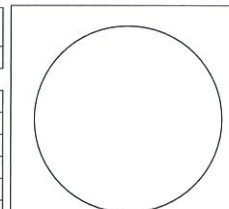

Date Stamped:

No.	Date	By	Revision



2515 'A' Street
Anchorage, Alaska 99503
Phone: (907) 276-4245
FAX: (907) 258-4653
www.stantec.com

Project:
HOMER PUBLIC SAFETY BUILDING
OPTION 2
COMBINED POLICE/FIRE - REDUCED PROGRAM

City of Homer
Homer, Alaska 99603

Project Mgr. DRS

Drawn

Checked

Date 12/04/14

Sheet Contents:
LEVEL 1 FLOOR PLAN

Sheet No.:

A-111

Project Number: 204600234



THIS DRAWING IS HALF-SIZE AT 11"x17"



POLICE STATION - SF BY DEPT.	
DEPARTMENT	AREA
DISPATCH	2570 SF
INVESTIGATION + PATROL	4568 SF
JAIL	4071 SF
POLICE LOBBY	894 SF
PROPERTY + EVIDENCE	4879 SF
RANGE	2540 SF
TRAINING + FITNESS	4207 SF
Grand total:	109 23728 SF

FIRE STATION - SF BY DEPT.	
DEPARTMENT	AREA
FIRE ADMIN	3086 SF
FIRE APPARATUS	7253 SF
FIRE APPARATUS SUPPORT	1343 SF
FIRE LIVING	3343 SF
FIRE LOBBY	1061 SF
Grand total:	44 16086 SF

COLOR LEGEND BY DEPARTMENT

- DISPATCH
- EXISTING
- FIRE ADMIN
- FIRE APPARATUS
- FIRE APPARATUS SUPPORT
- FIRE LIVING
- FIRE LOBBY
- INVESTIGATION + PATROL
- JAIL
- POLICE LOBBY
- PROPERTY + EVIDENCE
- RANGE
- TRAINING + FITNESS

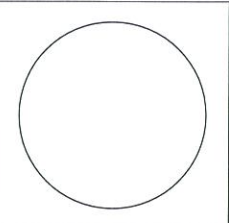

Date Stamped: _____

REVISIONS	
No.	Date



Project: HOMER PUBLIC SAFETY BUILDING

OPTION 2
COMBINED POLICE/FIRE - REDUCED PROGRAM

City of Homer
Homer, Alaska 99603

Project Mgr.	DRS
Drawn	
Checked	
Date	10/24/14

Sheet Contents:
LEVEL 2 FLOOR PLAN

Sheet No.:
A-112

Project Number: 204600234



POLICE STATION - ROOM SCHEDULE		
DEPARTMENT	ROOM NAME	AREA
DISPATCH	BREAK ROOM	306 SF
DISPATCH	DISPATCH CONSOLS	915 SF
DISPATCH	DISPATCH EQUIP.	140 SF
DISPATCH	LOCKERS	169 SF
DISPATCH	RECEP.	128 SF
DISPATCH	Room	63 SF
DISPATCH	STAIRS	160 SF
DISPATCH	SUPERVISOR	133 SF
DISPATCH	W/C	62 SF
DISPATCH	W/C	143 SF
DISPATCH	W/C	143 SF
DISPATCH	WORK FILES	208 SF
INVESTIGATION + PATROL	BREIFING SQUAD	462 SF
INVESTIGATION + PATROL	CUBICAL	64 SF
INVESTIGATION + PATROL	CUBICAL	66 SF
INVESTIGATION + PATROL	CUBICAL	74 SF
INVESTIGATION + PATROL	CUBICAL	77 SF
INVESTIGATION + PATROL	DET.	150 SF
INVESTIGATION + PATROL	DET.	150 SF
INVESTIGATION + PATROL	DET.	150 SF
INVESTIGATION + PATROL	HALLWAY	1446 SF
INVESTIGATION + PATROL	INT.	120 SF
INVESTIGATION + PATROL	LIEUT.	144 SF
INVESTIGATION + PATROL	PATROL STOR.	150 SF
INVESTIGATION + PATROL	POLI	98 SF
INVESTIGATION + PATROL	POLICE CHEIF	216 SF
INVESTIGATION + PATROL	REPORT WRITE/ OFFICE WORK	375 SF
INVESTIGATION + PATROL	SGT.	180 SF
INVESTIGATION + PATROL	SGT.	180 SF
INVESTIGATION + PATROL	SOFT INTERVIEW	144 SF
INVESTIGATION + PATROL	STAIRS	181 SF
INVESTIGATION + PATROL	WORK/COPY	143 SF
JAIL	CELL	76 SF
JAIL	CELL	81 SF
JAIL	CELL	110 SF
JAIL	CELL	112 SF
JAIL	CELL	112 SF
JAIL	CELL	113 SF
JAIL	CELL	115 SF
JAIL	CELL	132 SF
JAIL	CONTROL WS	300 SF
JAIL	ELEV./EQUIP.	74 SF
JAIL	HALLWAY	105 SF
JAIL	HALLWAY	125 SF
JAIL	HALLWAY	178 SF
JAIL	HALLWAY	180 SF
JAIL	HALLWAY	188 SF
JAIL	INTER - VIEW	90 SF
JAIL	INTER - VIEW	87 SF
JAIL	JAN/ REC.	88 SF
JAIL	LAUNDRY	85 SF
JAIL	MECH.	263 SF
JAIL	PRE BOOK	561 SF
JAIL	SHWR	42 SF
JAIL	SOFT INTERVIEW	203 SF
JAIL	TEMP. EVIDENCE	97 SF
JAIL	TEMP. HOLD	80 SF
JAIL	UNIFORMS/ BEDDING	94 SF
JAIL	VISABLE	10 SF
JAIL	VISIBLE	7 SF
JAIL	VISIBLE	8 SF
JAIL	VISIBLE	8 SF
JAIL	VISIBLE	8 SF

POLICE STATION - ROOM SCHEDULE			
DEPARTMENT	ROOM NAME	AREA	
JAIL	VISIBLE	10 SF	
JAIL	VISIT	36 SF	
JAIL	VISIT	36 SF	
JAIL	W/C	47 SF	
JAIL	W/C	56 SF	
JAIL	WOMEN	153 SF	
POLICE LOBBY	ELEV.	80 SF	
POLICE LOBBY	ELEV.	80 SF	
POLICE LOBBY	POLICE LOBBY	182 SF	
POLICE LOBBY	POLICE LOBBY	552 SF	
PROPERTY + EVIDENCE	BOOTS	47 SF	
PROPERTY + EVIDENCE	BUNK	171 SF	
PROPERTY + EVIDENCE	DECON/ DRESS	157 SF	
PROPERTY + EVIDENCE	DRUGS	65 SF	
PROPERTY + EVIDENCE	EQUIP / STOR.	115 SF	
PROPERTY + EVIDENCE	EVIDENCE RECIEVE	258 SF	
PROPERTY + EVIDENCE	EVIDENCE STOR.	139 SF	
PROPERTY + EVIDENCE	EVIDENCE SUBMIT	164 SF	
PROPERTY + EVIDENCE	GEAR	47 SF	
PROPERTY + EVIDENCE	GUNS	65 SF	
PROPERTY + EVIDENCE	HALLWAY	201 SF	
PROPERTY + EVIDENCE	HALLWAY	361 SF	
PROPERTY + EVIDENCE	LAUNDRY	81 SF	
PROPERTY + EVIDENCE	LDRY	88 SF	
PROPERTY + EVIDENCE	LONG TERM ECIDENCE STOR.	835 SF	
PROPERTY + EVIDENCE	LONG TERM EVIDENCE STOR.	255 SF	
PROPERTY + EVIDENCE	MARI- JAUANA	79 SF	
PROPERTY + EVIDENCE	PROP.	48 SF	
PROPERTY + EVIDENCE	SALLY PORT	1024 SF	
PROPERTY + EVIDENCE	STOR.	20 SF	
PROPERTY + EVIDENCE	SUPPLY	81 SF	
PROPERTY + EVIDENCE	VEHICLE IMPOUND BAY	580 SF	
RANGE	ARMORY	106 SF	
RANGE	CONTROL	100 SF	
RANGE	GUN CLEAN	109 SF	
RANGE	RANGE	1945 SF	
RANGE	STAIRS	181 SF	
RANGE	STOR.	98 SF	
TRAINING + FITNESS	FIRE/POLICE TRAINING	719 SF	
TRAINING + FITNESS	HALLWAY	207 SF	
TRAINING + FITNESS	LIBRARY	205 SF	
TRAINING + FITNESS	PHYSICAL TRAINING + EXERCISE	1098 SF	
TRAINING + FITNESS	POLICE SHOWER + LOCKERS	600 SF	
TRAINING + FITNESS	POLICE SHOWER + LOCKERS	1039 SF	
TRAINING + FITNESS	STAIR	137 SF	
TRAINING + FITNESS	TRAINING STOR.	203 SF	
Grand total: 109		23728 SF	

POLICE STATION - SF BY DEPT.		
DEPARTMENT	AREA	
DISPATCH	2570 SF	
INVESTIGATION + PATROL	4568 SF	
JAIL	4071 SF	
POLICE LOBBY	894 SF	
PROPERTY + EVIDENCE	4879 SF	
RANGE	2540 SF	
TRAINING + FITNESS	4207 SF	
Grand total: 109		23728 SF

FIRE STATION - ROOM SCHEDULE		
DEPARTMENT	ROOM NAME	AREA
FIRE ADMIN	ASSISTANT FIRE CHEIF	134 SF
FIRE ADMIN	FIRE CHEIF	154 SF
FIRE ADMIN	HALLWAY	120 SF
FIRE ADMIN	HALLWAY	429 SF
FIRE ADMIN	M+E	28 SF
FIRE ADMIN	MECH.	201 SF
FIRE ADMIN	MED. SUPPLY	218 SF
FIRE ADMIN	NEW TURN OUTS	244 SF
FIRE ADMIN	RECEPTION/ DEPT. SERVICES	354 SF
FIRE ADMIN	SEVICES SPECIALISTS	209 SF
FIRE ADMIN	STORAGE	218 SF
FIRE ADMIN	VOLUNTEER PRODUCTION	324 SF
FIRE ADMIN	W.C.	140 SF
FIRE ADMIN	W.C.	140 SF
FIRE ADMIN	W/C	84 SF
FIRE ADMIN	W/C	89 SF
FIRE APPARATUS	FIRE APPARATUS	6083 SF
FIRE APPARATUS	VEHICLE BAY	1170 SF
FIRE APPARATUS SUPPORT	AIR COMP. + STOR.	128 SF
FIRE APPARATUS SUPPORT	DECON SHOWERS	200 SF
FIRE APPARATUS SUPPORT	EQUIP / SUPPLIES	65 SF
FIRE APPARATUS SUPPORT	FACILITY MAINT.	210 SF
FIRE APPARATUS SUPPORT	HOSE W/D	65 SF
FIRE APPARATUS SUPPORT	SHOP	287 SF
FIRE APPARATUS SUPPORT	STORAGE	224 SF
FIRE APPARATUS SUPPORT	TURN OUT W/D	165 SF
FIRE LIVING	BUNK	130 SF
FIRE LIVING	BUNK	130 SF
FIRE LIVING	BUNK	162 SF
FIRE LIVING	BUNK	179 SF
FIRE LIVING	BUNK	189 SF
FIRE LIVING	BUNK	193 SF
FIRE LIVING	DAY ROOM	1103 SF
FIRE LIVING	DINNING	451 SF
FIRE LIVING	HALLWAY	137 SF
FIRE LIVING	JAN.	80 SF
FIRE LIVING	KITCHEN	413 SF
FIRE LIVING	PANTRY	80 SF
FIRE LIVING	STORAGE	94 SF
FIRE LOBBY	BREEZE WAY	184 SF
FIRE LOBBY	EQUIP.	92 SF
FIRE LOBBY	FIRE LOBBY	120 SF
FIRE LOBBY	FIRE LOBBY	557 SF
FIRE LOBBY	IT	108 SF
44		16086 SF

FIRE STATION - SF BY DEPT.		
DEPARTMENT	AREA	
FIRE ADMIN	3086 SF	
FIRE APPARATUS	7253 SF	
FIRE APPARATUS SUPPORT	1343 SF	
FIRE LIVING	3343 SF	
FIRE LOBBY	1061 SF	
Grand total: 44		16086 SF

TOTAL - SF BY DEPT.		
DEPARTMENT	AREA	
DISPATCH	2570 SF	
FIRE ADMIN	3086 SF	
FIRE APPARATUS	7253 SF	
FIRE APPARATUS SUPPORT	1343 SF	
FIRE LIVING	3343 SF	
FIRE LOBBY	1061 SF	
INVESTIGATION + PATROL	4568 SF	
JAIL	4071 SF	
POLICE LOBBY	894 SF	
PROPERTY + EVIDENCE	4879 SF	
RANGE	2540 SF	
TRAINING + FITNESS	4207 SF	
Grand total: 153		39813 SF

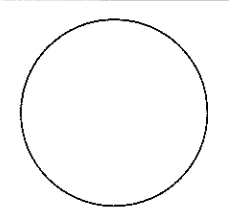

Date Stamped:	
By	
REVISIONS	
Revision	
No.	
Date	



Project: HOMER PUBLIC SAFETY BUILDING

OPTION 2

COMBINED POLICE/FIRE - REDUCED PROGRAM

City of Homer
Homer, Alaska 99603

Project Mgr. DRS

Drawn

Checked

Date 11/03/15

Sheet Contents:
ROOM SCHEDULE

Sheet No.:
A-600

Project Number: 204600234

OPTION 3 : REPLACE POLICE ONLY (LONG TERM) + UPGRADE EXISTING FIRE STATION

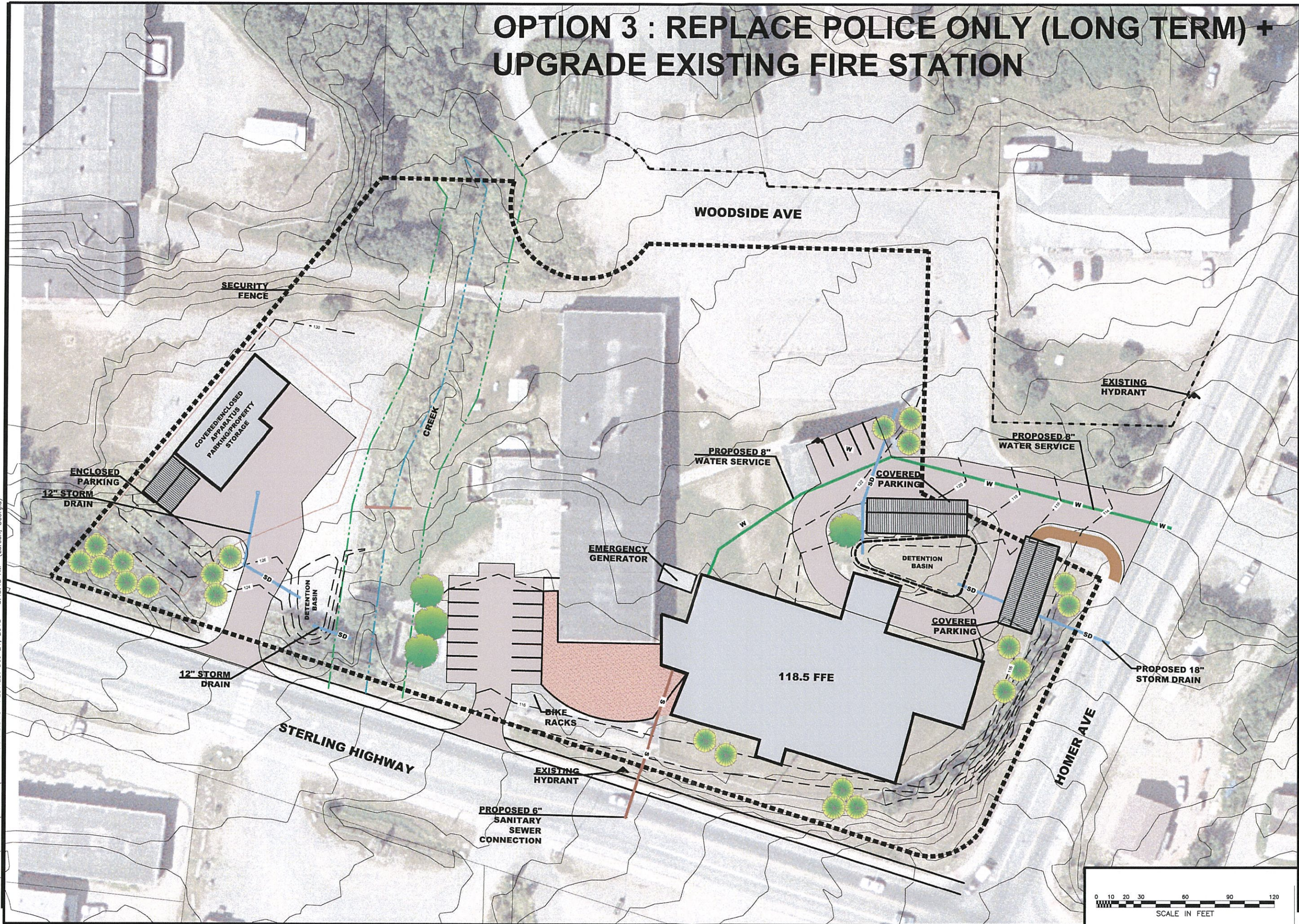

FILE: C:\USERS\GLARSEN\DESKTOP\L-SP-OPTION 3.DWG PLOTTED: Dec 21, 2015 8:43:48 AM (Larsen, Georgia)

Date Stamped:

No.	Date	By

Stantec
 2515 A Street
 Anchorage, Alaska 99503
 Phone: (907) 274-4245
 Fax: (907) 258-4653
 www.stantec.com

Project:
HOMER PUBLIC SAFETY BUILDING

City of Homer
 Homer, Alaska 99603

Project Mgr.	DRS
Drawn	
Checked	
Date	12/17/2015

Sheet Contents:
OPTION 3

Sheet No.:

L1.3

Project Number: 204600234

THIS DRAWING IS HALF-SIZE AT 11"x17"

0 10 20 30 60 90 120
 SCALE IN FEET
 IMAGE DATE: 05/12/2011

POLICE STATION - SF BY DEPT.	
DEPARTMENT	AREA
DISPATCH	2863 SF
INVESTIGATION + PATROL	4568 SF
JAIL	3778 SF
POLICE LOBBY	864 SF
PROPERTY + EVIDENCE	4879 SF
RANGE	2309 SF
TRAINING + FITNESS	5404 SF
Grand total:	108 24664 SF

COLOR LEGEND BY DEPARTMENT

- DISPATCH
- EXISTING
- INVESTIGATION + PATROL
- JAIL
- POLICE LOBBY
- PROPERTY + EVIDENCE
- RANGE
- TRAINING + FITNESS

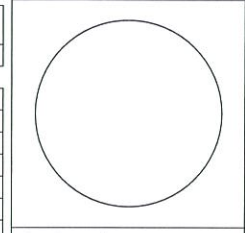

Date Stamped:

No.	Date	By

2515 'A' Street
Anchorage, Alaska 99503
Phone: (907) 276-4245
Fax: (907) 258-4653
www.stantec.com

Project:
HOMER PUBLIC SAFETY BUILDING
OPTION 3
POLICE ONLY/UPGRADE
EXISTING FIRE STATION

City of Homer
Homer, Alaska 99603

Project Mgr. DRS

Drawn

Checked

Date 10/30/14

Sheet Contents:
LEVEL 1 FLOOR PLAN

Sheet No.:
A-101

Project Number: 204600234



EXISTING BUILDING

EXISTING GYMNASIUM + BUILDING
REMAINS OPEN + FUNCTIONAL
DURING PHASE 1

SEPARATION BETWEEN EXISTING
BLDG + PROPOSED POLICE FACILITY

TEMP. PUBLIC ENTRY

POLICE LOBBY

DISPATCH

EMERGENCY
EXIT STAIR

JAIL

INVESTIGATION +
PATROL

**PROPOSED POLICE
FACILITY**

POLICE OFFICER +
STAFF ENTRY

C:\Users\Public\Documents\Local_Revit_Files\Arch_homer_safety_bldg_204600234_OPTION 3_gls.rvt

1 LEVEL 1
A-101 1/16" = 1'-0"



THIS DRAWING IS HALF-SIZE AT 11"x17"

C:\Users\Public\Documents\Local_Revit_Files\Arch_homer_safety_bldg_204600234_OPTION 3_glpasen.rvt

1 LEVEL 2
A-102 1/16" = 1'-0"

EXISTING BUILDING

EXISTING GYMNASIUM + BUILDING
REMAINS OPEN + FUNCTIONAL
DURING PHASE 1

ROOF BELOW

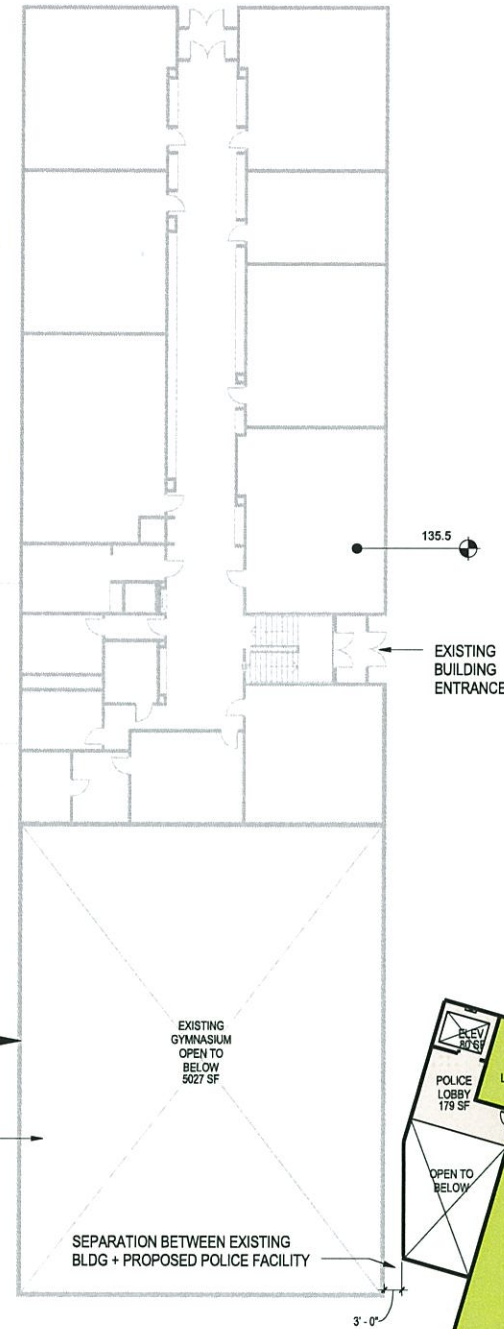

PROPOSED POLICE FACILITY

POLICE STATION - SF BY DEPT.	
DEPARTMENT	AREA
DISPATCH	2863 SF
INVESTIGATION + PATROL	4568 SF
JAIL	3778 SF
POLICE LOBBY	864 SF
PROPERTY + EVIDENCE	4879 SF
RANGE	2309 SF
TRAINING + FITNESS	5404 SF
Grand total: 108	24664 SF

COLOR LEGEND BY DEPARTMENT

 DISPATCH
 EXISTING
 INVESTIGATION + PATROL
 JAIL
 POLICE LOBBY
 RANGE
 TRAINING + FITNESS

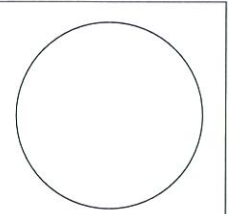

Date Stamped:

No.	Date	By

2815 A Street
Anchorage, Alaska 99503
Phone: (907) 276-4245
FAX: (907) 258-4653
www.stantec.com

Project:
HOMER PUBLIC SAFETY BUILDING

OPTION 3
POLICE ONLY/UPGRADE
EXISTING FIRE STATION

City of Homer
Homer, Alaska 99603

Project Mgr.	DRS
Drawn	
Checked	
Date	10/31/14

Sheet Contents:
LEVEL 2 FLOOR PLAN

Sheet No.:
A-102

Project Number: 204600234



THIS DRAWING IS HALF-SIZE AT 11"x17"

POLICE STATION - ROOM SCHEDULE		
DEPARTMENT	ROOM NAME	AREA
DISPATCH	BREAK	306 SF
DISPATCH	DISPATCH CONSOLS	915 SF
DISPATCH	DISPATCH EQUIP	140 SF
DISPATCH	HALLWAY	105 SF
DISPATCH	HALLWAY	188 SF
DISPATCH	LOCKERS	169 SF
DISPATCH	RECEP.	128 SF
DISPATCH	STAIRS	160 SF
DISPATCH	SUPERVISOR	133 SF
DISPATCH	W/C	62 SF
DISPATCH	W/C	63 SF
DISPATCH	W/C	143 SF
DISPATCH	W/C	143 SF
DISPATCH	WORK/ FILES	208 SF
INVESTIGATION + PATROL	BREIFING SQUAD	462 SF
INVESTIGATION + PATROL	CUBICAL	64 SF
INVESTIGATION + PATROL	CUBICAL	66 SF
INVESTIGATION + PATROL	CUBICAL	74 SF
INVESTIGATION + PATROL	CUBICAL	77 SF
INVESTIGATION + PATROL	DET.	150 SF
INVESTIGATION + PATROL	DET.	150 SF
INVESTIGATION + PATROL	HALLWAY	1446 SF
INVESTIGATION + PATROL	INT.	120 SF
INVESTIGATION + PATROL	LIEUT.	144 SF
INVESTIGATION + PATROL	PATROL STOR.	150 SF
INVESTIGATION + PATROL	POLI- GRAPH	98 SF
INVESTIGATION + PATROL	POLICE CHIEF	216 SF
INVESTIGATION + PATROL	REPORT WRITE/ OFFICE WORK	375 SF
INVESTIGATION + PATROL	SGT.	150 SF
INVESTIGATION + PATROL	SGT.	180 SF
INVESTIGATION + PATROL	SGT.	180 SF
INVESTIGATION + PATROL	SOFT INTER- VIEW	144 SF
INVESTIGATION + PATROL	STAIRS	181 SF
INVESTIGATION + PATROL	WORK/ COPY	143 SF
JAIL	CELL	76 SF
JAIL	CELL	81 SF
JAIL	CELL	110 SF
JAIL	CELL	112 SF
JAIL	CELL	112 SF
JAIL	CELL	113 SF
JAIL	CELL	115 SF
JAIL	CELL	132 SF
JAIL	CONTROL WS	300 SF
JAIL	ELEV.EQUIP	74 SF
JAIL	HALLWAY	125 SF
JAIL	HALLWAY	153 SF
JAIL	HALLWAY	178 SF
JAIL	HALLWAY	180 SF
JAIL	INTER- VIEW	87 SF
JAIL	INTER- VIEW	90 SF
JAIL	JAN./REC.	88 SF
JAIL	LAUNDRY	85 SF
JAIL	MECH.	263 SF
JAIL	PRE BOOK	561 SF
JAIL	SHWR	42 SF
JAIL	SOFT INTERVIEW	203 SF
JAIL	TEMP. EVIDENCE	97 SF
JAIL	TEMP. HOLD	80 SF
JAIL	UNIFORMS/ BEDDING	94 SF
JAIL	VISIT	36 SF
JAIL	VISIT	36 SF
JAIL	VISUAL CUT OFF	10 SF
JAIL	VISUAL CUTOFF	7 SF

POLICE STATION - ROOM SCHEDULE		
DEPARTMENT	ROOM NAME	AREA
JAIL	VISUAL CUTOFF	8 SF
JAIL	VISUAL CUTOFF	8 SF
JAIL	VISUAL CUTOFF	8 SF
JAIL	VISUAL CUTOFF	10 SF
JAIL	W/C	47 SF
JAIL	W/C	56 SF
POLICE LOBBY	ELEV.	80 SF
POLICE LOBBY	ELEV.	80 SF
POLICE LOBBY	POLICE LOBBY	179 SF
POLICE LOBBY	POLICE LOBBY	525 SF
PROPERTY + EVIDENCE	BOOTS	47 SF
PROPERTY + EVIDENCE	BUNK	171 SF
PROPERTY + EVIDENCE	DECON/ DRESS	157 SF
PROPERTY + EVIDENCE	DRUGS	65 SF
PROPERTY + EVIDENCE	EQUIP./ STOR.	115 SF
PROPERTY + EVIDENCE	EVIDENCE RECIEVE	258 SF
PROPERTY + EVIDENCE	EVIDENCE STOR.	139 SF
PROPERTY + EVIDENCE	EVIDENCE SUBMIT	164 SF
PROPERTY + EVIDENCE	GEAR	47 SF
PROPERTY + EVIDENCE	GUNS	65 SF
PROPERTY + EVIDENCE	HALLWAY	201 SF
PROPERTY + EVIDENCE	HALLWAY	361 SF
PROPERTY + EVIDENCE	LAUNDRY	81 SF
PROPERTY + EVIDENCE	LONG TERM EVIDENCE STOR.	835 SF
PROPERTY + EVIDENCE	LONG TERM EVIDENCE STORAGE	255 SF
PROPERTY + EVIDENCE	MARI- JAUANA	79 SF
PROPERTY + EVIDENCE	PROP.	48 SF
PROPERTY + EVIDENCE	SALLY PORT	1024 SF
PROPERTY + EVIDENCE	STOR.	20 SF
PROPERTY + EVIDENCE	SUPPLY	81 SF
PROPERTY + EVIDENCE	UNIFORM	88 SF
PROPERTY + EVIDENCE	VEHICLE IMPOUND BAY	580 SF
RANGE	ARMORY	106 SF
RANGE	CONTROL	147 SF
RANGE	GUN CLEAN	109 SF
RANGE	RANGE	1848 SF
RANGE	STOR.	98 SF
TRAINING + FITNESS	FIRE/POLICE TRAINING	719 SF
TRAINING + FITNESS	HALLWAY	344 SF
TRAINING + FITNESS	MEN'S SHOWERS + LOCKERS	1277 SF
TRAINING + FITNESS	PHYSICAL TRAINING + EXERCISE	1679 SF
TRAINING + FITNESS	STAIR	181 SF
TRAINING + FITNESS	TRAIN. OFFICE	205 SF
TRAINING + FITNESS	TRAIN. STOR./ LAUNDRY	203 SF
TRAINING + FITNESS	WOMEN'S SHOWERS + LOCKERS	796 SF

Grand total: 108 24664 SF

TOTAL - SF BY DEPT.	
DEPARTMENT	AREA
DISPATCH	2863 SF
INVESTIGATION + PATROL	4568 SF
JAIL	3778 SF
POLICE LOBBY	864 SF
PROPERTY + EVIDENCE	4879 SF
RANGE	2309 SF
TRAINING + FITNESS	5404 SF

Grand total: 108 24664 SF

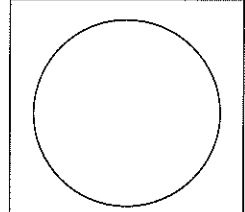

Date Stamped:	
By	
REVISIONS	
Revision	
Date	
No.	

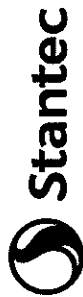

2515 K Street
Anchorage, Alaska 99503
Phone: (907) 276-4245
Fax: (907) 258-4653
www.stantec.com

Project:
HOMER PUBLIC SAFETY BUILDING

OPTION 3
POLICE ONLY/UPGRADE
EXISTING FIRE STATION

City of Homer
Homer, Alaska 99603

Project Mgr.	DRS
Drawn	
Checked	
Date	11/03/15

Sheet Contents:
ROOM SCHEDULE

Sheet No.:
A-600

Project Number: 204600234

Conceptual Cost Estimate - Three Options

Homer Public Safety Building Project

December 20, 2015

CONSTRUCTION ITEMS	OPTION 1 Combined Police/Fire-Original Program			OPTION 2 Combined Police/Fire-Reduced Program			OPTION 3 Police Only/Upgrade Exist. Fire Station		
	Quantity	Unit	TOTAL	Quantity	Unit	TOTAL	Quantity	Unit	TOTAL

CIVIL SITE									
Mob/Demob/General Conditions	LS	LS	\$260,000	LS	LS	\$260,000	LS	LS	\$170,000
Building Demolition	LS	LS	\$550,000	LS	LS	\$550,000	LS	LS	\$220,000
Excavation - On-Site Disposal	12,000	CY	\$4	12,000	CY	\$4	6,000	CY	\$4
Excavation - Off-Site Disposal	4,250	CY	\$10	4,250	CY	\$10	1,750	CY	\$10
Import Select Fill Material	9,000	CY	\$25	9,000	CY	\$25	4,500	CY	\$25
Paving (2" LC/2" AC)	35,000	SF	\$5	35,000	SF	\$5	14,000	SF	\$5
Curb & Gutter	5,000	LF	\$22	5,000	LF	\$22	850	LF	\$22
Sidewalk/Trails	LS	LS	\$50,000	LS	LS	\$50,000	LS	LS	\$15,000
Storm Drainage	LS	LS	\$75,000	LS	LS	\$75,000	LS	LS	\$50,000
Water Service/Hydrant	LS	LS	\$45,000	LS	LS	\$45,000	LS	LS	\$45,000
Sewer Service	LS	LS	\$25,000	LS	LS	\$25,000	LS	LS	\$25,000
Landscaping/Seeding	LS	LS	\$55,000	LS	LS	\$55,000	LS	LS	\$35,000
Public Plaza	LS	LS	\$35,000	LS	LS	\$35,000	LS	LS	\$32,000
Detention Basins	LS	LS	\$30,000	LS	LS	\$30,000	LS	LS	\$30,000
Gas/Electric/Tele Service	LS	LS	\$105,000	LS	LS	\$105,000	LS	LS	\$105,000
Utility Relocations	LS	LS	\$130,000	LS	LS	\$130,000	LS	LS	\$80,000
Site Lighting	LS	LS	\$60,000	LS	LS	\$60,000	LS	LS	\$25,000
SWPPP	LS	LS	\$50,000	LS	LS	\$50,000	LS	LS	\$30,000
Dumpster/Pad/Enclosure	LS	LS	\$15,000	LS	LS	\$15,000	LS	LS	\$15,000
Emergency Generator	LS	LS	\$120,000	LS	LS	\$120,000	LS	LS	\$120,000
SUBTOTAL CIVIL SITE			\$2,205,500				\$2,205,500		

UPGRADE EXISTING FIRE STATION									
Bay Ventilation Improvements	LS	LS	\$250,000	LS	LS	\$250,000	LS	LS	\$250,000
Bay Lengthening (Additional 4-5 feet	LS	LS	\$480,000	LS	LS	\$480,000	LS	LS	\$480,000
Add Unheated Covered Storage	LS	LS	\$140,000	LS	LS	\$140,000	LS	LS	\$140,000
Paint Exterior	LS	LS	\$75,000	LS	LS	\$75,000	LS	LS	\$75,000
Replace Exterior Stairway (west side)	LS	LS	\$30,000	LS	LS	\$30,000	LS	LS	\$30,000
SUBTOTAL UPGRADE EXIST. FIRE						\$975,000			

ASSESSORY - POLICE									
Vehicle Impound Bay	523	sf	\$350	523	sf	\$350	523	sf	\$350
Vehicle Impound Storage	1962	sf	\$150	1500	sf	\$150	1500	sf	\$150
Stolen Item Storage	872	sf	\$50	500	sf	\$50	500	sf	\$50
Staff Vehicle Enclosed Parking	1,199	sf	\$275	1,199	sf	\$275	1,199	sf	\$275
Staff Vehicle Covered Parking	981	sf	\$200	981	sf	\$200	981	sf	\$200
K-9	55	sf	\$150	55	sf	\$150	55	sf	\$150
SUBTOTAL ACCESSORY STRUCTURES			\$1,346,720				\$1,237,220		

MAIN BUILDING									
Fire Administration	4,173	sf	\$325	3,086	sf	\$325	3,086	sf	\$325
Fire Apparatus Bays	7,749	sf	\$350	7,253	sf	\$350	7,253	sf	\$350
Fire Apparatus Support	1,435	sf	\$325	1,343	sf	\$325	1,343	sf	\$325
Fire Living	4,167	sf	\$350	3,343	sf	\$325	3,343	sf	\$325
Fire Lobby	2,165	sf	\$350	1,061	sf	\$350	1,061	sf	\$350
Police Lobby	1,429	sf	\$325	864	sf	\$325	864	sf	\$325
Police Dispatch	3,381	sf	\$375	2,863	sf	\$375	2,863	sf	\$375
Police Investigations and Patrol	5,411	sf	\$350	4,568	sf	\$350	4,568	sf	\$350
Police Property/Evidence	4,879	sf	\$325	4,879	sf	\$325	4,879	sf	\$325
Police Jail	4,560	sf	\$625	3,778	sf	\$625	3,778	sf	\$625
Police Range	2,359	sf	\$550	2,359	sf	\$550	2,359	sf	\$550
Training and Fitness	10,221	sf	\$325	4,207	sf	\$325	4,207	sf	\$325
Communications	51,929	sf	\$4	39,604	sf	\$4	39,604	sf	\$4
Furnishings	51,929	sf	\$5	39,604	sf	\$5	39,604	sf	\$5
SUBTOTAL MAIN BUILDING			\$19,899,411				\$15,440,686		

TOTAL CONSTRUCTION			\$21,246,131				\$16,677,906		
---------------------------	--	--	---------------------	--	--	--	---------------------	--	--

DESIGN/INSPECTION/ADMINISTRATION									
Design	8	%	-	-	-	\$1,699,690	-	-	\$1,334,232
1% for Art			-	-	-	\$198,994	-	-	\$154,407
Construction Assistance/Inspection	2	%	-	-	-	\$424,923	-	-	\$333,558
Contingency	12	%	-	-	-	\$2,549,536	-	-	\$2,001,349
City Administration	2	%	-	-	-	\$424,923	-	-	\$333,558
SUBTOTAL DESIGN/INSPECTION						\$5,298,066	\$4,157,104		

TOTAL PROJECT COST			\$28,749,697				\$23,040,510		
---------------------------	--	--	---------------------	--	--	--	---------------------	--	--