

BRUSH CUTTING: Maintaining Our Roads & Right-of-Ways

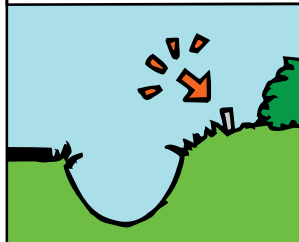

R.O.W.'s ARE USED FOR UTILITIES, SIDEWALKS, DITCHES, AND ARE SUBJECT TO CITY MAINTENANCE. SO BE SURE TO FIND WHERE YOUR PROPERTY LINE ENDS AND THE R.O.W. BEGINS BEFORE PLANTING THAT ROSEBUSH!

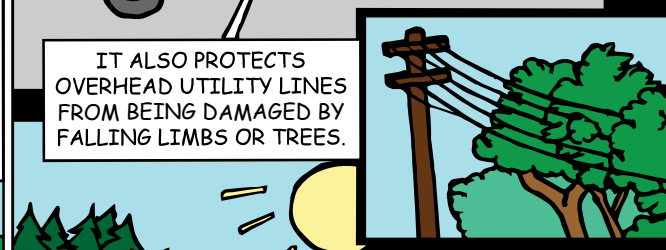
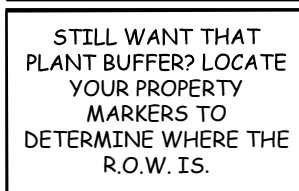
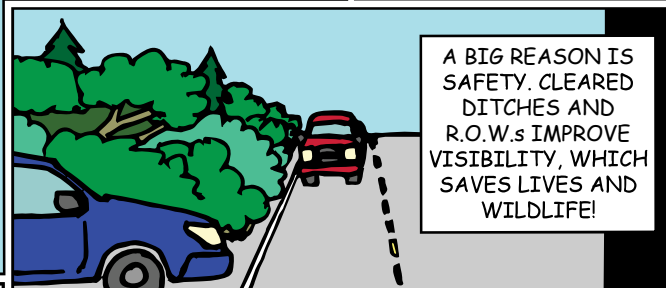
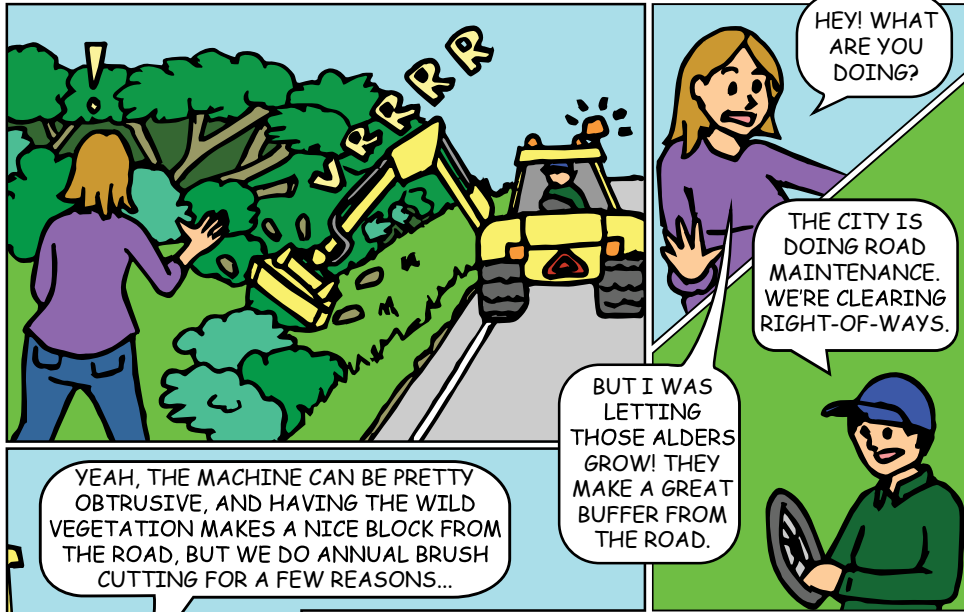
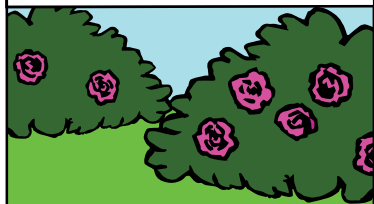

Help Us Help the Community!

We want safe roadways for all and appreciate everyone's understanding.

Brush cutting begins Monday, May 16th and will take place in phases. Visit www.cityofhomer-ak.gov/publicworks for more information and a map of the phased areas to be cleared.

Questions? Call Public Works 907-235-3170